

bore 60 - 220 mm

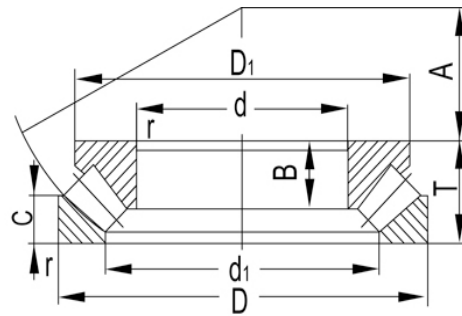

Basic Dimensions (mm)									Basic load (kn)		Speed ratings(rpm)		Weight kg	Bearing No.
d	D	T	d1	D1	B	C	A	r min	Cr	Cor	Ref	Limit		
60	130	42	86	117.7	15	20.1	38	1.5	270	765	2600	4500	2.75	29412
65	140	45	93	126.8	16	21.3	42	2	325	920	2200	4300	3.41	29413
70	150	48	99.5	136.3	17	22.7	44	2	365	980	2000	4000	4.1	29414
75	160	51	106	145.8	18	24.3	47	2	415	1140	1800	3800	4.98	29415
80	170	54	113	154.1	19	26.8	50	2.1	450	1240	1600	1800	5.95	29416
85	150	39	111	137.9	13	18.7	50	1.5	285	915	2000	3500	2.87	29317
	180	58	121	162.1	21	27.3	54	2.1	510	1450	1600	3600	7.19	29417
90	155	39	117.5	143.3	13	17.9	52	1.5	290	950	2000	3500	3.06	29318
	190	60	128	172	22	28.5	56	2.1	570	1620	1600	3200	8.28	29418
100	170	42	127.5	158	14	20.5	58	1.5	325	1100	1800	3000	3.91	29320
	210	67	141.5	190	24	32.4	62	3	680	1900	1400	2700	11.2	29420
110	190	48	144	177	16	22.1	64	2	430	1510	1600	2900	5.67	29322
	230	73	153.5	209.1	26	34.5	69	3	780	2340	1200	2400	14.7	29422
120	210	54	156	194.4	18	25.9	70	2.1	520	1740	1400	2600	7.96	29324
	250	78	170	225.4	28	36.6	74	4	915	2770	1200	2300	18.5	29424
130	225	58	168	208.7	19	27.8	76	2.1	600	2100	1400	2400	9.45	29326
	270	85	182.5	243.5	31	39.7	81	4	1100	3170	1100	2200	23.6	29426
140	240	60	181	221.4	20	28.9	82	2.1	670	2370	1200	2300	11.2	29328
	280	85	194	254.1	31	39.8	86	4	1160	3410	1000	2100	24.6	29428
150	250	60	191.5	232	20	29.8	87	2.1	695	2460	1200	2100	11.7	29330
	300	90	209.5	271.3	32	42.1	92	4	1250	3880	1000	2000	29.6	29430
160	270	67	205	250.5	23	31.7	92	3	815	2460	1100	2000	15.5	29332
	320	95	219	292.2	34	47.1	99	5	1430	4370	900	1800	35.9	29432
170	280	67	216.5	260.2	23	31.4	96	3	865	3010	1000	1900	16.3	29334
	340	103	234	309.2	37	48.6	104	5	1600	4810	850	1700	44	29434
180	250	42	209	239	15	21.3	97	1.5	420	3560	1300	2300	7.05	29236
	300	73	227.5	278.4	25	34.6	103	3	980	3730	1000	1800	20.7	29336
	360	109	249.5	327.5	39	51.9	110	5	1760	5500	800	1600	52.2	29436
190	270	48	224	254	15	24	103	2	500	2000	1300	2000	7.95	29238
	320	78	240.5	298.5	27	38.6	110	4	1140	6050	760	1600	25.5	29338
	380	115	262	345.3	41	54.9	117	5	1930	4010	800	1500	61.4	29438
200	280	48	236	271	15	24	108	2	512	2200	1300	2000	9.08	29240
	340	85	259	315.6	29	39.1	116	4	1290	4750	800	1500	32	29340
	400	122	278	363.2	44	57.5	122	5	2160	6820	760	1400	73	29440
220	300	48	258	287.3	15	23	117	2	540	2300	1200	2000	9.84	29244
	360	85	278.5	334.4	29	40.7	125	4	1340	5020	800	1500	34.5	29344
	420	122	300	383.2	44	56.9	132	6	2200	7710	680	1300	74.2	29444

bore 240 - 480 mm

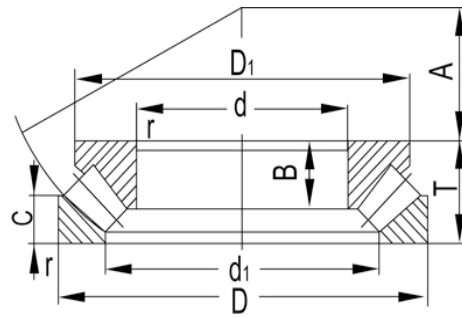

Basic Dimensions (mm)									Basic load (kn)		Speed ratings(rpm)		Weight kg	Bearing No.
d	D	T	d1	D1	B	C	A	r min	Cr	Cor	Ref	Limit		
240	340	60	282	332	19	29.3	160	2.1	788	3040	1000	1600	17.1	29248
	380	85	299	353.7	27	41.7	135	4	1370	5270	800	1400	36.3	29348
	440	122	318	402	44	56.9	142	6	2360	7650	630	1300	83	29448
260	360	60	303	324.4	19	29.7	139	2.1	815	3550	1000	1500	18.5	29252
	420	95	325	393.1	32	47.5	148	5	1370	6080	710	1200	51.5	29352
	480	132	343.5	440.8	48	64.7	154	6	2750	9050	630	1100	106	29452
280	380	60	323	362	19	29.5	150	2.1	850	3860	900	1500	19.5	29256
	440	95	364	412.5	32	46.3	158	5	1830	6750	710	1200	54	29356
	520	145	373.5	476.1	52	67.6	166	6	3150	10800	560	1000	137	29456
300	420	73	350.5	399.8	21	35.8	162	3	1140	3000	710	1200	31	29260
	480	109	371.5	447.8	37	53.1	168	5	2120	7850	630	1000	75.4	29360
	540	145	395	479.5	52	68.3	172	6	3350	10800	500	1000	146	29460
320	440	73	369.5	418.6	21	36	172	3	1140	3100	630	1200	32.8	29264
	500	109	393	468	37	53	180	5	2240	8900	560	1000	80	29364
	580	155	418	534.9	56	76.1	191	7.5	3800	13500	500	900	179	29464
340	460	73	395	439.2	21	36.5	183	3	1160	3200	630	1100	34.5	29268
	540	122	422	504	41	57.8	192	5	2600	9650	500	900	106	29368
	620	170	448.5	565.7	61	79.1	201	7.5	4300	15100	400	800	228	29468
360	500	85	419	475.4	25	40.8	194	4	1500	4050	550	900	50.4	29272
	560	122	442.5	475.3	41	58.1	202	5	2700	10700	400	900	140	29372
	640	170	468.5	565.7	61	81.6	210	7.5	4500	16200	350	750	234	29472
380	520	85	439	524.3	27	41.8	202	4	1530	4300	500	900	52.8	29276
	600	132	476	588.9	44	61.4	216	6	3200	12500	430	800	140	29376
	670	175	488.5	469.2	61	85.2	230	7.5	4650	17300	380	700	263	29476
400	540	85	459	515.3	27	41.9	212	4	1600	7600	600	900	55.1	29280
	620	132	490	564.9	44	64.7	225	6	3350	12800	430	900	146	29380
	710	185	515.5	621.1	67	92.3	236	7.5	5200	19700	350	650	314	29480
420	580	95	485	552.6	30	49.2	225	5	2000	5600	530	900	74.9	29284
	650	140	514.5	620	48	68	235	6	3570	13400	400	700	170	29384
	730	185	520	675.3	67	91.2	244	7.5	5400	20200	330	600	325	29484
440	600	95	505	573.8	30	49.3	235	5	2040	9680	530	800	79	29288
	680	145	539	637.3	49	70.8	245	6	3800	14800	380	750	192	29388
	780	206	572	715.7	74	101.6	260	9.5	6200	23400	280	650	421	29488
460	620	95	535	597.8	30	49.6	245	5	2080	10000	500	750	80.9	29292
	710	150	559.5	665.1	51	74.4	257	6	4150	16200	350	600	216	29392
	800	206	596.5	737.1	74	99.9	272	9.5	6400	25100	280	650	435	29492

bore 480 - 1600 mm

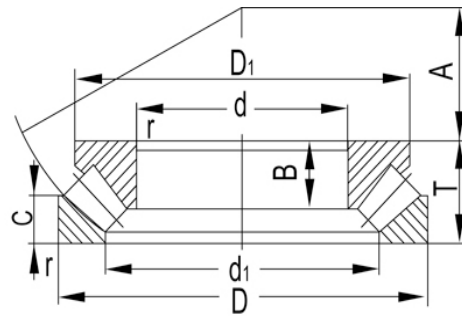

Basic Dimensions (mm)									Basic load (kn)		Speed ratings(rpm)		Weight kg	Bearing No.
d	D	T	d1	D1	B	C	A	r min	Cr	Cor	Ref	Limit		
480	650	103	556	635	33	55	259	5	2150	11800	460	700	98	29296
	730	150	582	686	51	74.4	270	6	4300	16700	350	700	224	29396
	850	224	628.5	782.2	71	106.5	280	9.5	7350	27000	240	570	534.2	29496
500	670	103	571.5	641	33	50.5	268	5	2240	12500	460	700	101	292/500
	750	150	603	707.1	51	73.2	280	6	4400	17700	330	600	231	293/500
	870	224	641	798.8	81	109.8	290	9.5	7550	28800	240	570	559	294/500
530	710	109	604.5	679.7	35	54	288	5	2800	16200	430	650	108	292/530
	800	160	642	752.7	54	78.6	295	7.5	5170	26300	300	550	270	293/530
	920	236	682.5	849.5	85	113.3	309	9.5	9000	41600	220	430	650	294/530
560	750	115	639	717.9	37	57.7	302	5	3090	18100	380	600	140	292/560
	850	175	675	797	60	87	310	7.5	5790	47800	250	500	320	293/560
	980	250	722.5	905.6	90	122.5	328	12	10210	47800	200	450	740	294/560
600	800	122	685.5	965.4	39	59.4	321	5	4320	20100	350	500	172	292/600
	900	180	723.5	845.5	61	88	335	7.5	6350	32600	240	430	368	293/600
	1030	258	766	1050	110	136	347	12	12700	52800	200	400	880	294/600
630	850	132	720	812.6	42	67.3	338	6	4030	23900	300	500	218	292/630
	950	190	763.5	895.6	65	93.9	345	9.5	7070	37000	240	430	438	293/630
	1090	280	830	1040	100	136	365	12	13700	58200	180	400	1000	294/630
670	1000	200	803	939.1	68	98.2	372	9.5	7720	40300	280	430	501	293/670
710	950	145	810.5	909.5	46	73.4	380	6	4840	29400	150	300	261	292/710
	1060	212	848.5	994.1	72	105.2	394	9.5	8570	45100	180	350	579	293/710
	1220	308	925	1165	113	150	415	15	16800	71000	180	300	1500	294/710
750	1000	150	854	958.6	48	76.8	406	6	5180	31900	240	460	130	292/750
	1120	224	917.5	1061.3	76	108	415	9.5	9370	50600	200	380	696	293/750
	1280	315	972	1152	160	158	436	15	17500	75000	150	300	1650	294/750
800	1060	155	907.5	1.17.6	50	79.2	426	7.5	5620	35300	220	430	339	292/800
	1180	230	948	1108	78	116.1	440	9.5	10110	54900	200	350	780	293/800
850	1120	160	961	1076.7	51	82.9	453	7.5	6080	38900	200	400	389	292/850
900	1180	170	1018.5	1132.2	54	84.5	477	7.5	6590	42000	180	350	444	292/900
950	1250	180	1081	1185	58	88	507	7.5	7030	38000	160	330	600	292/950
	1600	390	1209	1470	153	191	546	15	23900	112000	100	200	3065	294/950
1060	1400	206	1211	1325	66	100	566	9.5	8900	49000	120	260	860	292/1060
	1770	426	1349	1615	192	207	610	15	28300	132000	100	200	4280	294/1060
1180	1520	206	1331	1450	83	101	623	9.5	9200	54000	120	240	950	292/1180
1250	1800	330	1474	1685	148	161	698	12	21000	109000	100	200	2770	293/1250
1600	2280	408	1885	2130	166	195	894	19	31000	170000	40	80	5380	293/1600